

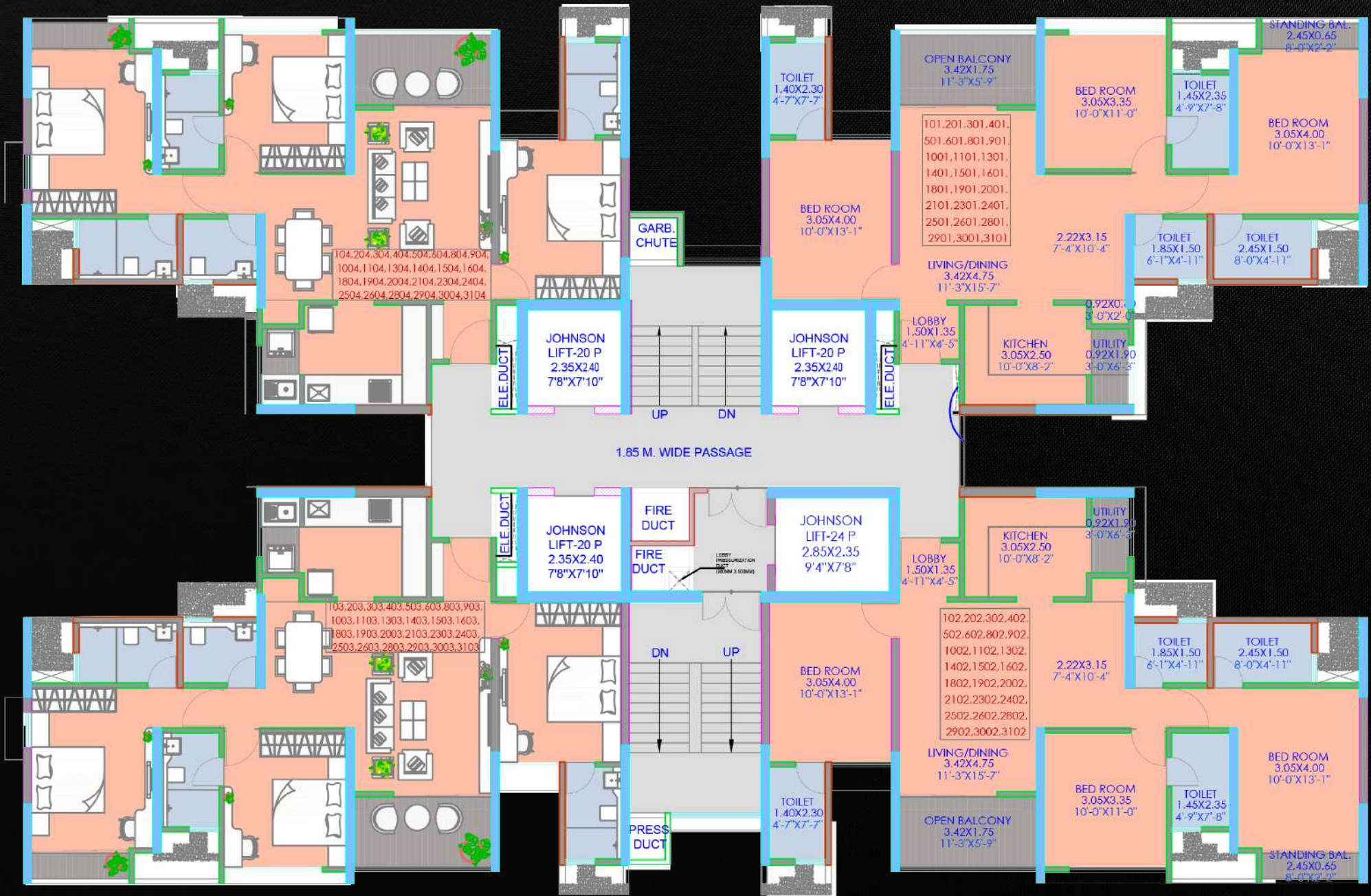

# TYPICAL FLOOR PLAN - TOWER B

3BHK : Carpet Area - 1066 sq.ft. | Saleable Area - 1493 sq.ft.







# REFUGE FLOOR PLAN - TOWER B

3BHK : Carpet Area - 1066 sq.ft. | Saleable Area - 1493 sq.ft.

2BHK : Carpet Area - 836 sq.ft. | Saleable Area - 1170 sq.ft.







# TYPICAL FLOOR PLAN - TOWER E

3 BHK : Carpet Area - 1010 sq.ft. | Saleable Area - 1414 sq.ft.

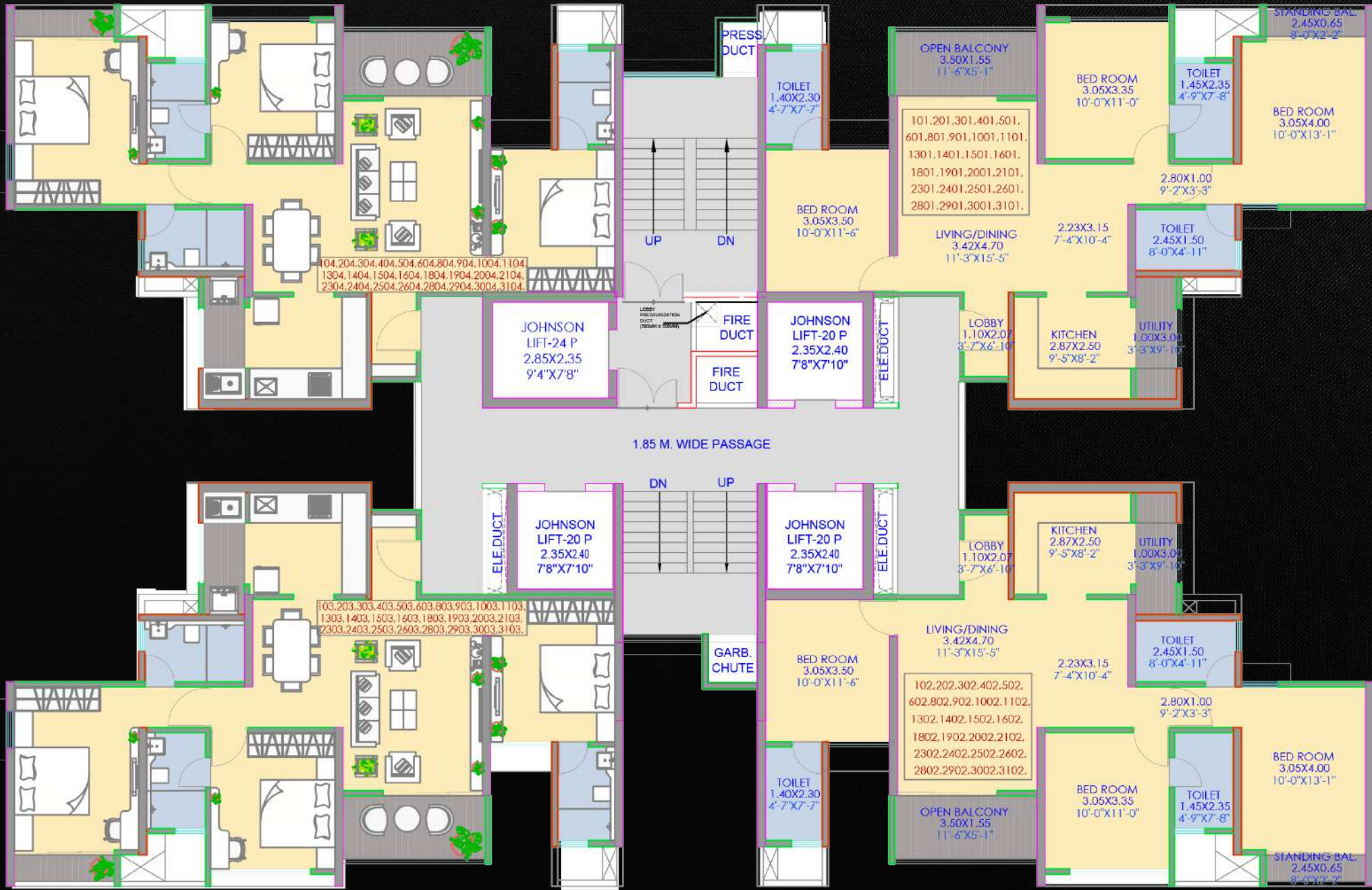





# REFUGE FLOOR PLAN - TOWER E

3 BHK : Carpet Area - 1010 sq.ft. | Saleable Area - 1414 sq.ft.

2 BHK : Carpet Area - 823 sq.ft. | Saleable Area - 1152 sq.ft.







# TYPICAL FLOOR PLAN - TOWER A

4BHK : Carpet Area - 1717 sq.ft. | Saleable Area - 2403 sq.ft.







# REFUGE FLOOR PLAN - TOWER A

4BHK : Carpet Area - 1717 sq.ft. | Saleable Area - 2403 sq.ft.

3BHK : Carpet Area - 1398 sq.ft. | Saleable Area - 1957 sq.ft.







# TYPICAL FLOOR PLAN - TOWER F

2 BHK : Carpet Area - 798 sq.ft. | Saleable Area - 1117 sq.ft.







# REFUGE FLOOR PLAN - TOWER F

2 BHK : Carpet Area - 798 sq.ft. | Saleable Area - 1117 sq.ft.

